

Dynamics of Critical Care Conference 2017

Exhibit Hall (July 25)

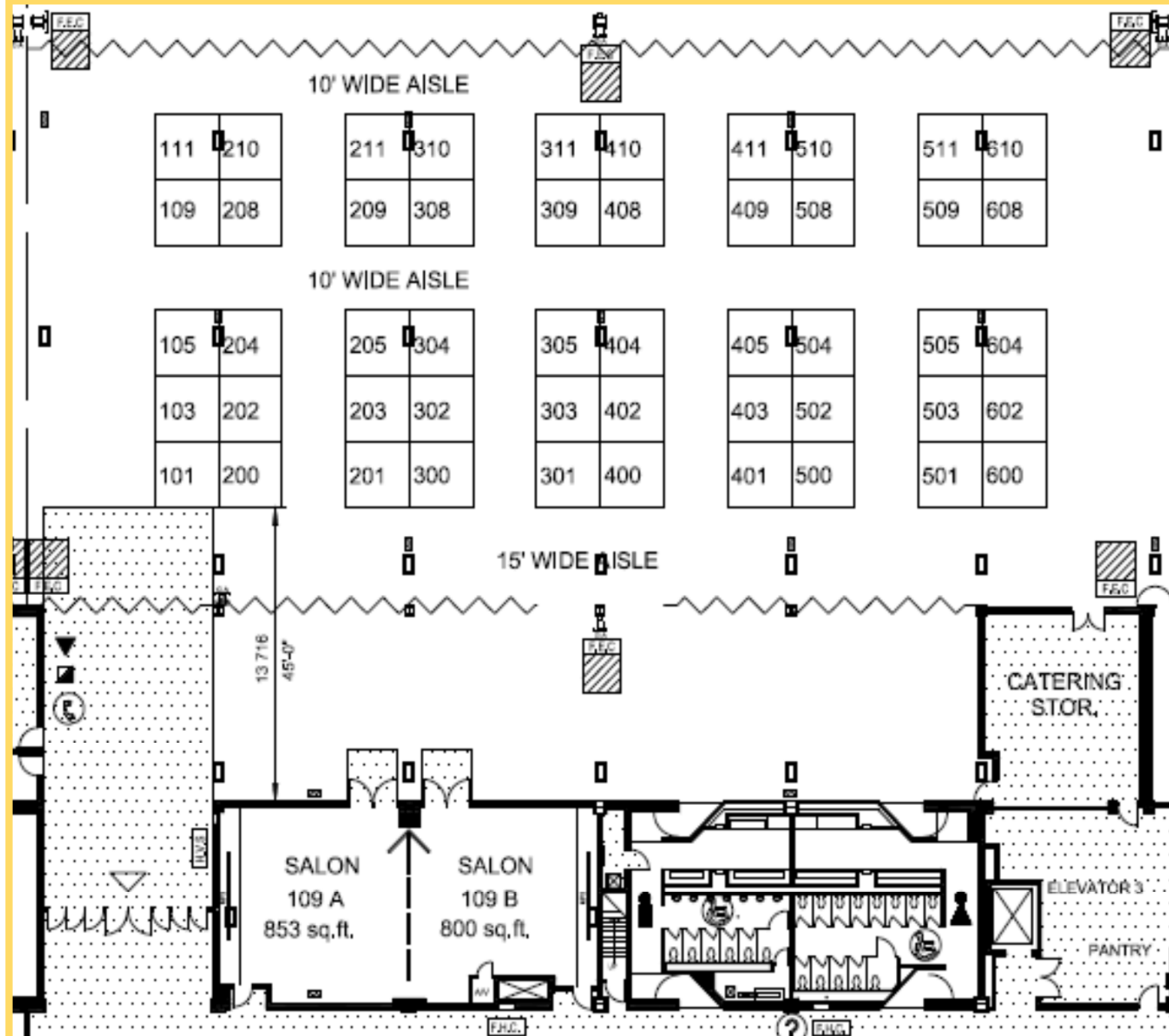

| Company | Booth # |
|--------------------------------------|---------------|
| Amico Corporation | 311 |
| Arjo Huntleigh | 209, 211 |
| Bard Canada | 200 |
| Baxter Corporation | 300, 302, 304 |
| BBraun Medical of Canada | 202, 204 |
| BD Medical | 309, 408 |
| Bosse Medica Inc | 508 |
| Canadian Hospital Specialties | 305 |
| Canadian Nurses Association | 203 |
| CardioMed Supplies Inc | 103 |
| Dale Medical Products | 301 |
| Draeger Medical Canada Inc | 210 |
| Edwards Life Sciences | 410 |
| Elsevier | 501 |
| Exergen Corporation | 409 |
| Everest Group USA Inc | 402 |
| Fraser Health Authority | 411 |
| Fresenius Kabi Canada Ltd | 404 |
| GE Healthcare | 201 |
| Hill-Rom Canada | 509, 511 |
| Masimo | 608 |
| Molnlycke | 503 |
| Natural Steps | 502 |
| Nestle Health Sciences | 105 |
| Northern Health | 510 |
| Nunavut Nurses | 303 |
| Omega Laboratories | 205 |
| Original Energy Sales | 500 |
| Pfizer Canada | 111 |
| Philips Canada | 109, 208 |
| Provincial Health Services Authority | 505 |
| Sage Products | 405 |
| Spacelabs Healthcare | 308, 310 |
| Southmedic Inc | 504 |
| Stryker Canada | 401, 403 |
| Vernacare | 400 |
| Zoll Medical | 101 |